

Ridgelight 25 - 40°

Ridgelight is a classic looking solution, consisting of two rows of skylights linked together at the ridge, creating a self-supporting structure. The flashing allows for installations with a pitch of 25 to 40°.

Due to horizontal forces, it is recommended to use a sub-construction of steel or concrete when mounting a ridgelight.

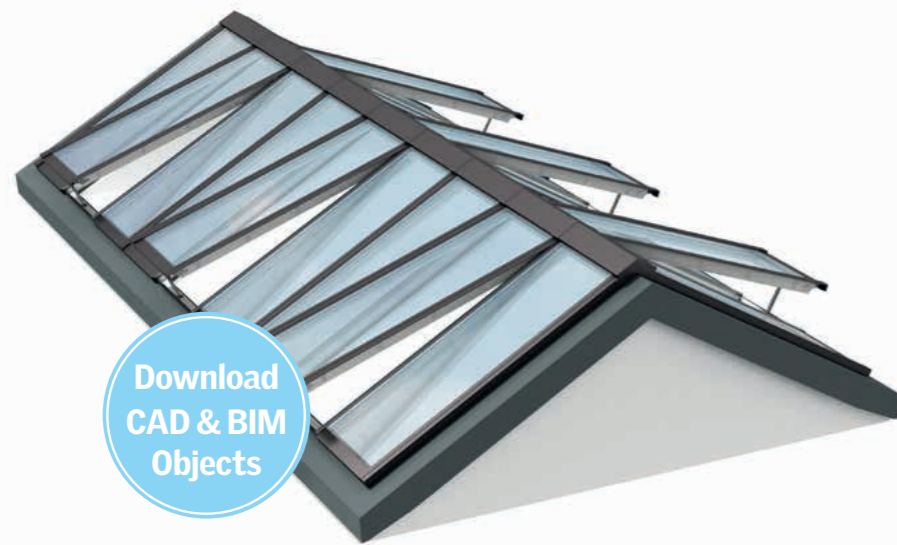

Download
CAD & BIM
Objects

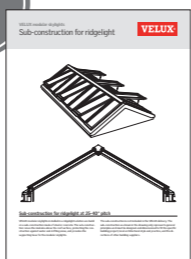

Sub-construction for ridgelight at velux.co.uk/modularskylights

Use the table to define module height (H) and/or installation pitch (α).

Example:
A = 3775 mm

Result:
α1: H = 2000 mm at installation pitch of 26°
or
α2: H = 2200 mm at installation pitch of 35.5°

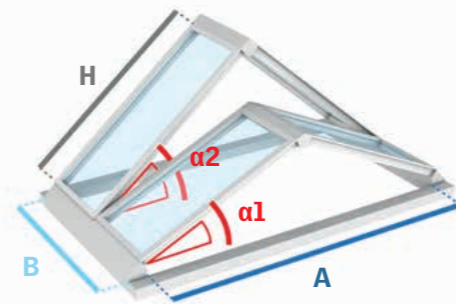

H: Module height
α: Installation pitch
A: Opening width
B: Opening length

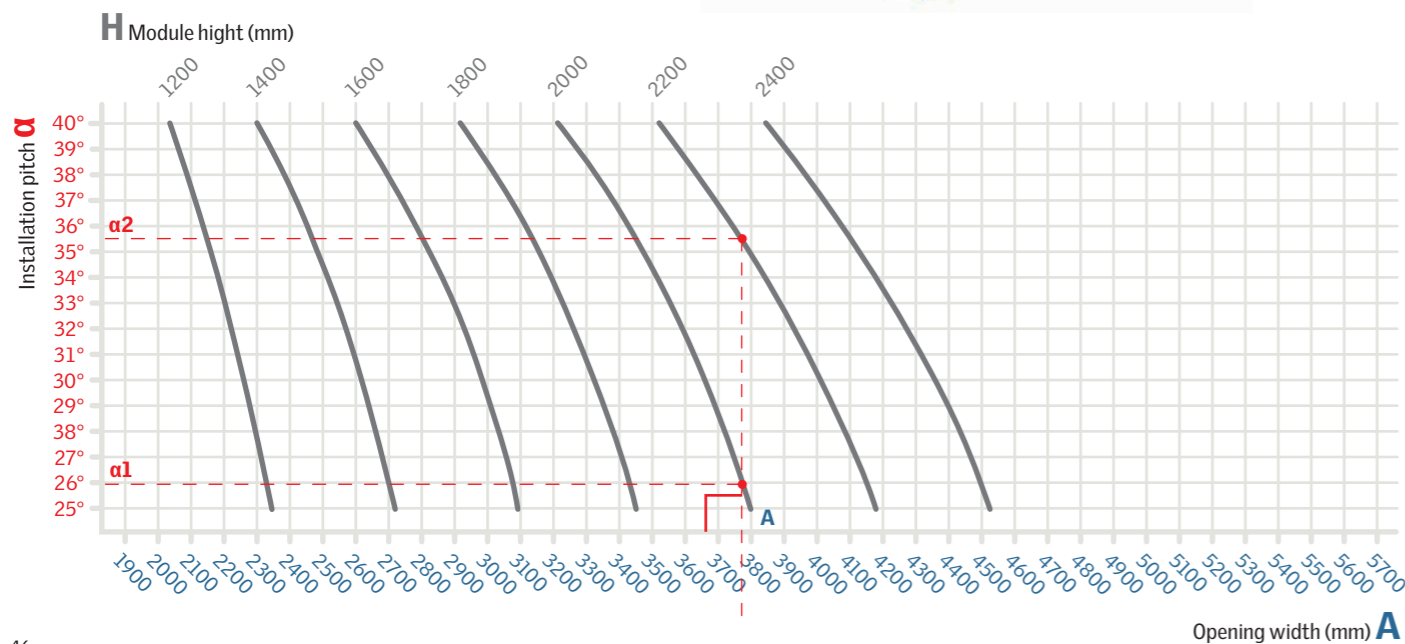

Opening width (mm) **A**

Sectional Drawings

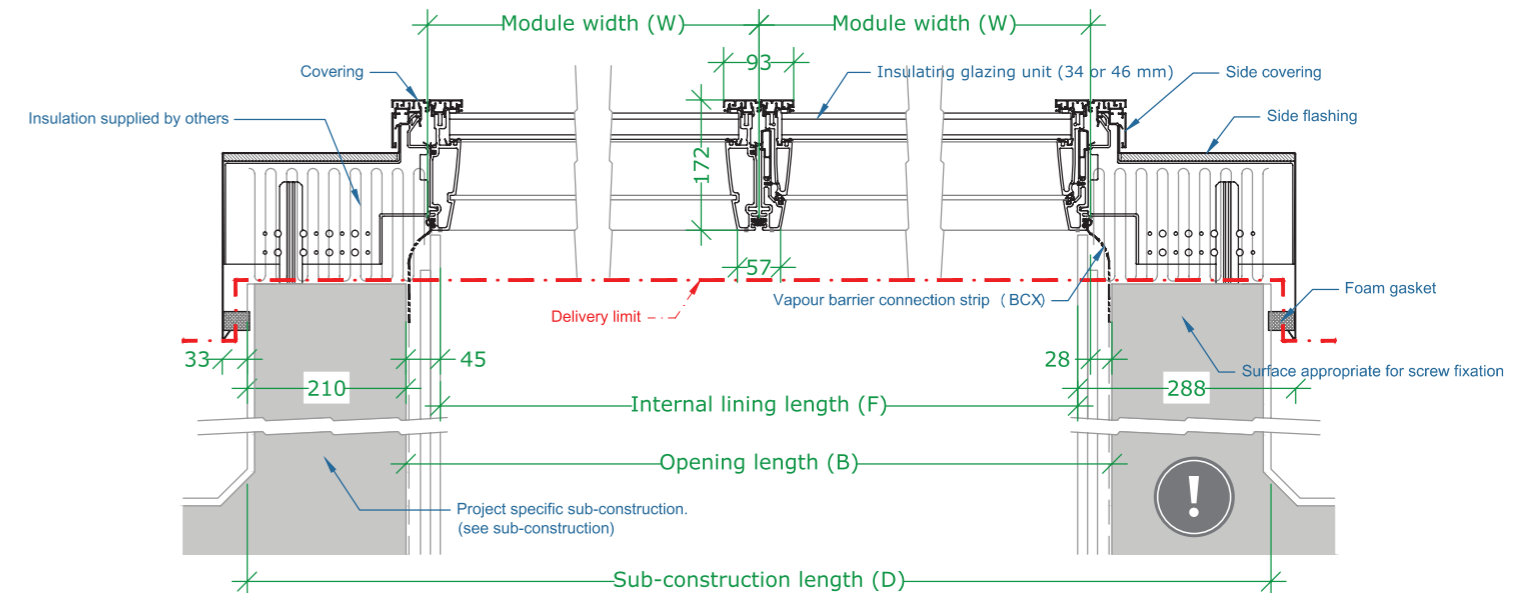
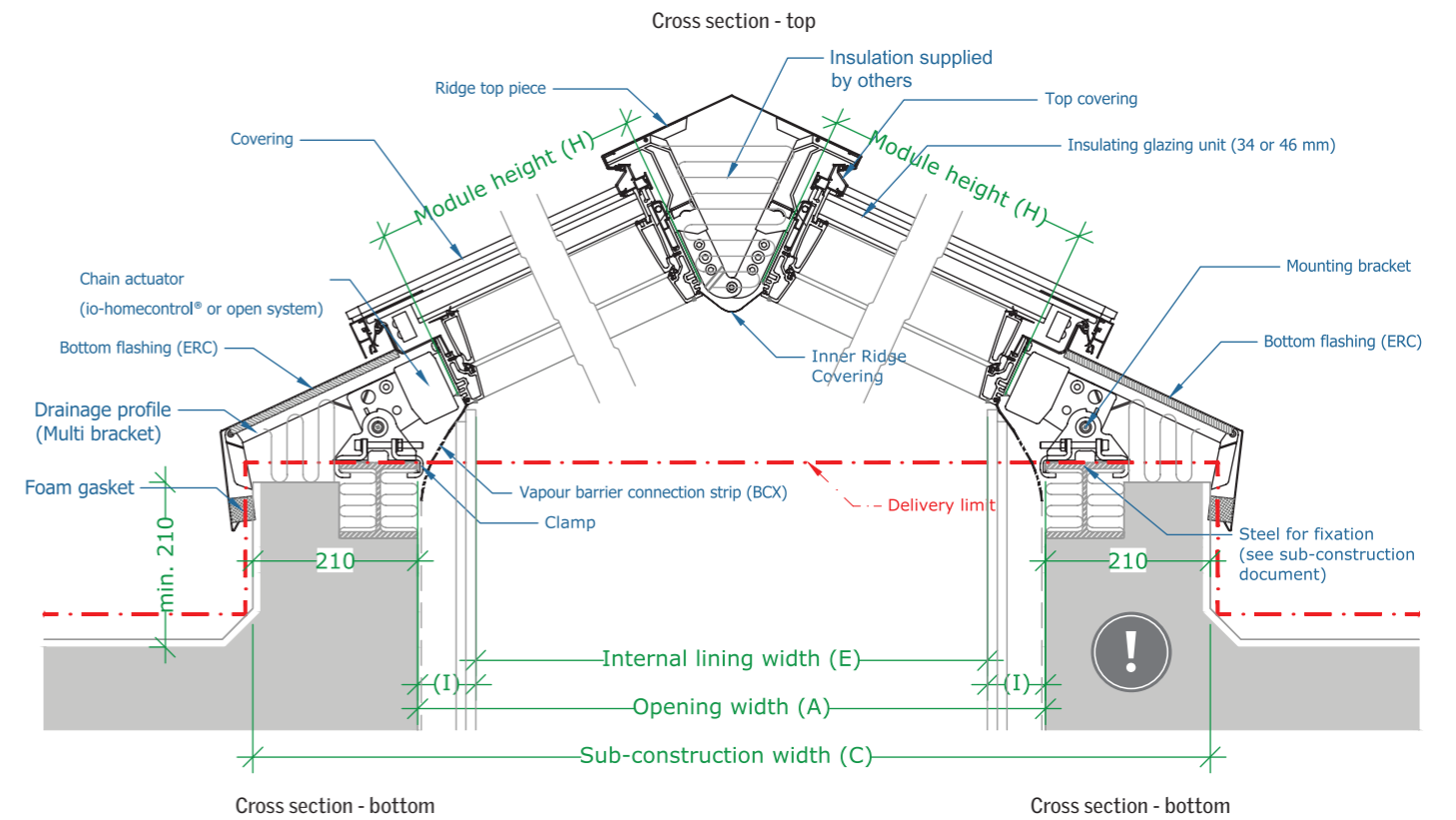

Longitudinal section

Note: Light fittings are not supplied by the VELUX Group. Max. point load is 5 kg per module connection.